



EMERGENCY INVITATION TO BID

DFCS Flooring Project

Bid Summary

The Evans County Board of Commissioners is accepting sealed bids for the purchase and installation of new flooring in the DFCS office area of the Courthouse Annex.

Bid Submittal and Approval Process

Vendors interested in bidding can fill out the attached Official Bid Sheet and submit it to the Evans County Board of Commissioners. All bids must be sealed and mailed / hand-delivered to the following address:

ATTN: MICHAEL LASALA, DFCS FLOORING PROJECT
EVANS COUNTY BOARD OF COMMISSIONERS
3 FREEMAN STREET
CLAXTON, GA 30417

Please note, ALL SPECIFICATIONS MUST BE MET for bid to be considered. The specifications and scope of work for this project are listed on the Official Bid Sheet attached to this Invitation to Bid. Any questions can be directed to Michael LaSala, Building & Grounds Superintendent, at (912) 290-1021.

Bids will be accepted until 4:30 PM on Wednesday, October 18, 2017 and will be opened shortly thereafter. Bids will be binding for a period of 90 days from the date they are opened. Evans County reserves the right to reject any and all bids, to accept in whole or in part such bids as may be deemed in the best interest of the County.

OFFICIAL BID SHEET

DFCS Flooring Project

EMERGENCY WORK SCOPE (Exhibit A)

1. Removing flood damaged carpet and cleaning the isolated area as shown on Exhibit A within 48 hours

WORK SCOPE & MATERIALS (Exhibit B)

1. Moving of furniture (before & after)
2. Removal & disposal of old flooring
3. Removal & disposal of old base
4. Subfloor preparation
5. Installation of new flooring (Shaw Grain Hard Surface LVT, glued down)
6. Installation of base (Johnsonite rubber, NOT VINYL)
7. Installation of rubber transition pieces (color-matched with base)

INCLUDED AREAS

Conference Room, EOC, Halls, Lobby, Offices

***Note:** Bathrooms, mechanical room closets, and area surrounding rolling filing cabinets will not be a part of this project. Please see attached floorplan for reference.*

| | |
|-----------------------|--|
| BUSINESS NAME | |
| CONTACT NAME | |
| CONTACT NUMBER | |

OFFICIAL BID SHEET (Cont.)
DFCS Flooring Project

EMERGENCY WORK SCOPE (Exhibit A)

| EMERGENCY WORK SCOPE (Exhibit A) | | |
|--|------------------------|-----------------|
| LABOR | COST / SQ. FOOT | SUBTOTAL |
| Removal of flood-damaged carpet and cleaning the isolated area as shown on Exhibit A within 48 hours | \$ | \$ |

| REMAINING WORK SCOPE (Exhibit B) | | |
|--|------------------------|-----------------|
| MATERIAL | COST / SQ. FOOT | SUBTOTAL |
| Shaw Grain Hard Surface LVT (glued down) | \$ | \$ |
| Commercial Carpet Installation (at least 11 stitches / inch) | \$ | \$ |
| Johnsonite Rubber Wall Base (not vinyl) | \$ | \$ |
| Rubber Transition Pieces (color-matched with base) | \$ | \$ |

TOTAL

| |
|-----------|
| \$ |
|-----------|

EXHIBIT A

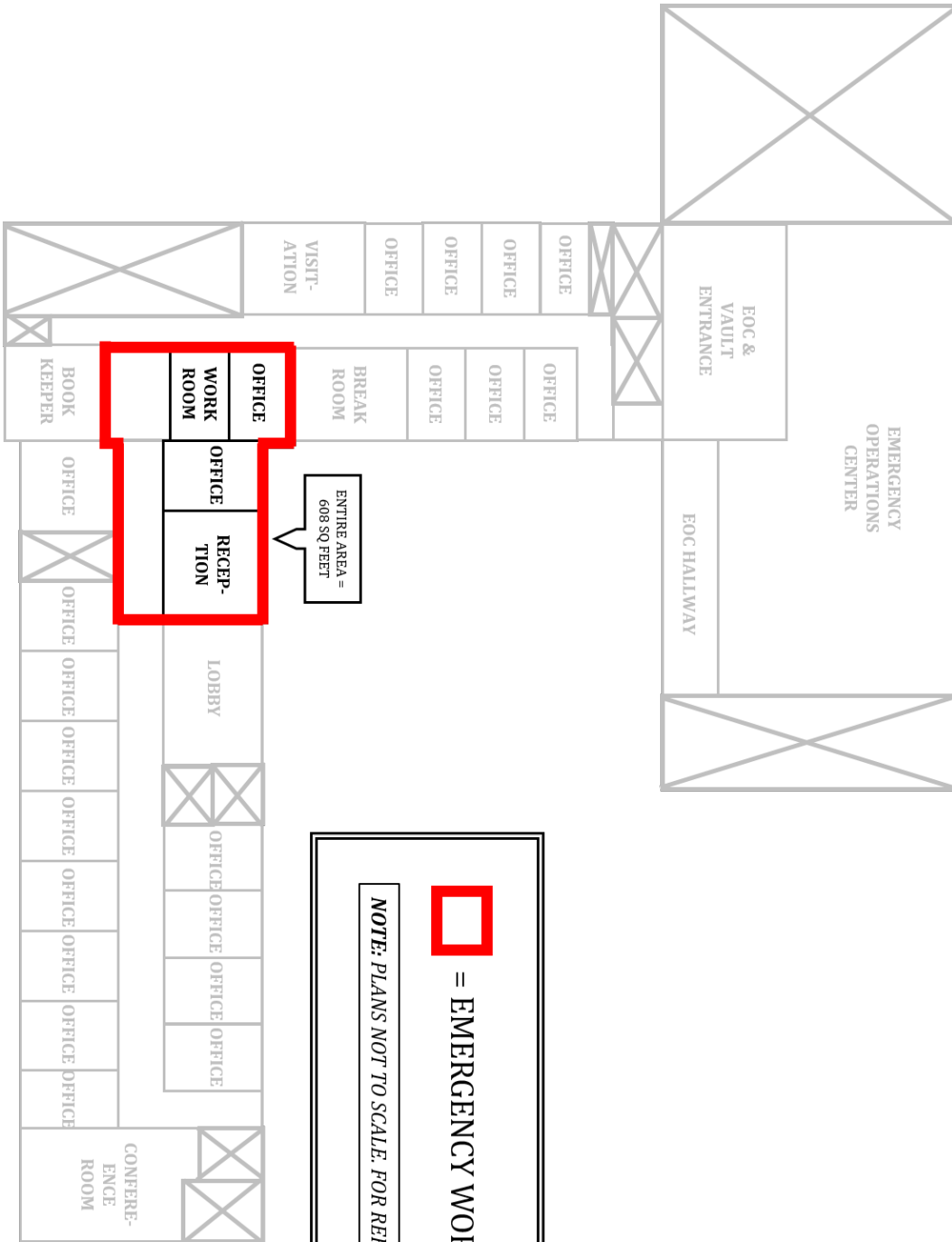

 = EMERGENCY WORK SCOPE

NOTE: PLANS NOT TO SCALE. FOR REFERENCE ONLY.

EXHIBIT B

